

Plat of Survey

of
**Part of Lot 12 in Block 3 of the Original
Plat of the Village of Williams Bay,**
located in the Northeast 1/4 of Section 1, Town 1 North, Range
16 East, Village of Williams Bay, Walworth County, Wisconsin.

A parcel of land described in a Warranty Deed recorded December 22, 2005 as Document No. 663463 as shown below:

**Tax Parcel
WOP 00040**

PARCEL A:
Part of Lot 12 of Block 3 of the Original Village of Williams Bay, Walworth County, Wisconsin described as follows, to-wit: Commencing at the Southeast corner of said Lot 12; thence South 67° 20' West 29.23 feet along the North line of Geneva Street to the place of beginning; thence continue on the same line 91.00 feet; thence North parallel to the West line of Block 3, 106.40 feet; thence East 68.87 feet; thence South 12° 07' East 73.00 feet to the place of beginning.

**Tax Parcel
WOP 00047**

PARCEL B:
Part of Lot 12 of Block 3 of the Plat of Williams Bay, which plat is recorded in the Office of the Register of Deeds for said County in Volume 4 of Plats on Page 31, as follows: Beginning at the Southwest corner of said Lot 12, thence North along the West line of said Lot, 78 feet more or less; thence Northeast parallel to the Southeastern line of said Lot, 69 feet more or less; thence Southeast at a right angle 31.5 feet more or less; thence Northeast at a right angle parallel to the Southeast line of said Lot 44.5 feet more or less; thence Southeast at a right angle 41 feet more or less to a point on the Southeastern line of said Lot 142.8 feet from the Southwest corner of said Lot; thence Southwesterly along the Southeast line of said Lot 142.8 feet to the place of beginning.

**Tax Parcel
WOP 00048**

PARCEL C:
All that certain piece or parcel of land lying and being in the incorporated Village of Williams Bay and more fully described as part of Lot 12 in Block 3 of the Plat of Williams Bay which plat is recorded in the Office of the Register of Deeds for Walworth County, Wisconsin in Volume 4 of Plats at Page 31 as follows, to-wit: Beginning at a gas pipe stake in the Southwest corner of said Lot 12; thence North along the West line of said Lot, 192 feet to a gas pipe stake; thence East 132 feet to an iron bolt; thence South on a line parallel with and 132 feet East of the West line of said Lot, 137.3 feet to a gas pipe stake on the Southeast line of the said Lot; thence Southwesterly along the Southeast line of the said Lot, 142.8 feet to the place of beginning. EXCEPTING THEREFROM that part of the above described premises described as follows: Part of Lot 12 in Block 3 of the Plat of Williams Bay, which plat is recorded in the said Register's office in said Volume 4 of Plats at Page 31, as follows: Beginning at a gas pipe stake in the Southwest corner of said Lot 12; thence North along the West line of said Lot, 78 feet more or less; thence Northeast parallel to the Southeast line of said Lot, 69 feet more or less; thence Southeast at a right angle 31.5 feet, more or less; thence Northeast at a right angle parallel to the Southeast line of said Lot, 44.5 feet, more or less; thence Southeast at a right angle 41 feet more or less to a point on the Southeastern line of said Lot, 142.8 feet from the Southwest corner of said Lot 12; thence Southwesterly along the Southeast line of said Lot, 142.8 feet to the place of beginning.

TAX KEY NO.: WOP 00040, WOP 00047 & WOP 00048

Surveyed for: **Hwy. 67 Plaza, LLC**
W3323 Lake Forest Lane
Lake Geneva, Wisconsin 53147

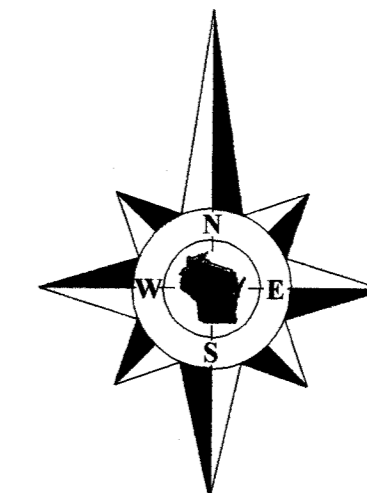

Bearings reference to the East line of Williams Street recorded as North on previous surveys of record.

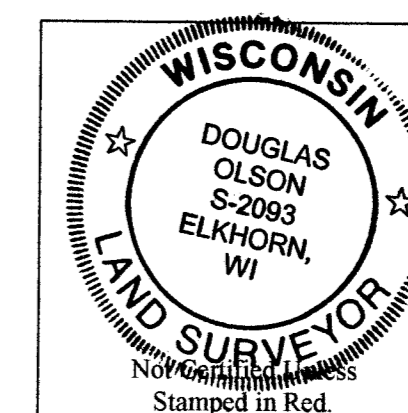

Notes:

- This survey plat is not certified unless signed and sealed in red ink.
- This survey is subject to Wisconsin lien laws. This Plat of Survey is the notice of intent to file lien. Lien waiver required.

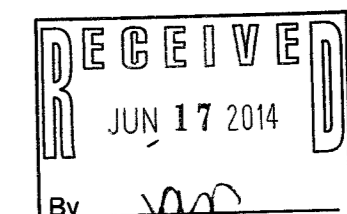

Copyright 2008 by Jensen & Olson Land Surveying, LLC.

All rights reserved. No part of this survey plat may be reproduced or transmitted in any form by any means - graphic, electronic, or mechanical, including photocopying, tracing, or information storage and retrieval systems - without permission in writing from Douglas G. Olson, Jensen & Olson Land Surveying, LLC.

I, Douglas G. Olson, Wisconsin Registered Land Surveyor, do hereby certify that this survey was performed by me, or under my direction in full compliance with the owner's/agent's instructions and Chapter A-E 7 of the Wisconsin Administrative Code "Minimum Standards for Property Surveys"; and that this map is an accurate representation thereof to the best of my knowledge and belief.

Douglas G. Olson
Wisconsin Registered Land Surveyor - 2093
WOP-47 WOP-40
WOP-48
011-2535

Jensen & Olson Land Surveying, LLC

45 South Wisconsin Street * P.O. Box 322 * Elkhorn, Wisconsin. 53121
Telephone: (262) 723-3434 * Facsimile: (262) 723-8044
Email: jensen.olson@elknet.net

Legend

- Found Iron Pipe
- Found Iron Rod 3/4" dia.
- Found Iron Rod 1/2" dia.
- Set Iron Rod 3/4" dia.
- Set Iron Rod 1/2" dia.
- Sec. Chained Crescent
- Utility Box or Pedestal
- Utility Pole
- Utility Pole
- Manhole or Metal Cover
- Asphalt Surface
- Concrete Surface
- Bollard
- Water Valve
- Water Meter
- Hotline Flag
- Concrete Surface

Sheet 1 of 1 Sheets

Job Reference Number
2012.108

2012.108